

AMERICAN QC SYSTEMS

Quick Switch Tooling

#1 Centering Canister Size	Part No:	#1 Centering Canister Holders Shank Size (A)	Part No:
ER-16	CN160001	1/2"	CH010500
		5/8"	CH010625
		3/4"	CH010750
		20mm	CH010787
		22mm	CH010866
		1"	CH011000
Largest Diameter D= 1.500"			

#2 Centering Canister Size	Part No:	#2 Centering Canister Holders Shank Size (A)	Part No:
ER-20	CN200002	3/4"	CH020750
ER-25	CN250002	22mm	CH020866
		1"	CH021000
		1-1/4"	CH021250
		1-1/2"	CH021500
		32mm	CH021260
Largest Diameter D= 2.000"			

#3 Centering Canister Size	Part No:	#3 Centering Canister Holders Shank Size (A)	Part No:
ER-32	CN32003	1-1/2"	CH031500
ER-40	CN40003	2"	CN032000
Largest Diameter D= 2.500"			

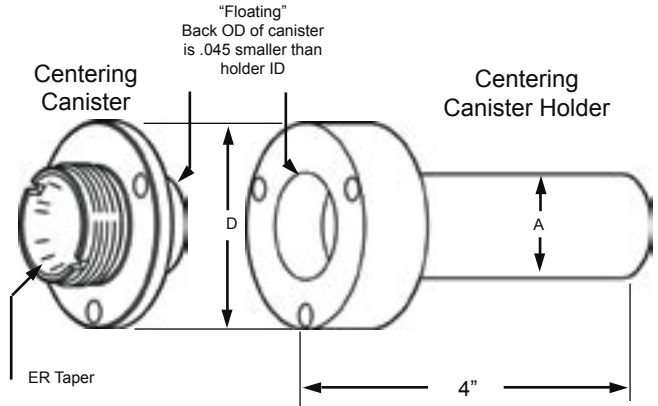

Straight Shank ER Holders		
ER Size	Shank Size	Part No:
ER-16	1/2"	SS160500
	5/8"	SS160625
	3/4"	SS160750
	1"	SS161000
	20mm	SS160787
	*20mm DE	SS1620DE
	22mm	SS160866
ER-20	*22mm DE	SS1622DE
	3/4"	SS200750
	22mm	SS200866
	1"	SS201000
	1-1/4"	SS201250
ER-25	32mm	SS201260
	3/4"	SS250750
	1"	SS251000
	1-1/4"	SS251250
ER-32	1-1/2"	SS251500
	1-1/4"	SS321250
	1-1/2"	SS321500
ER-40	2"	SS322000
	1-1/4"	SS401250
	1-1/2"	SS401500
	2"	SS402000
* DE = Double Ended		

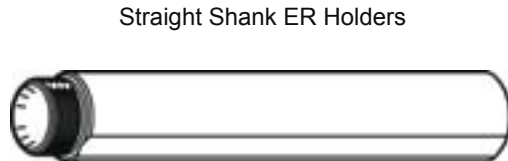

AMERICAN QC SYSTEMS
Quick Switch Tooling

ER-11 Adaptor System

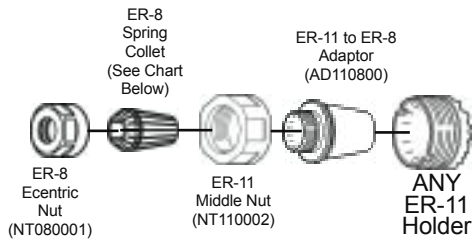

ER-8 Collets

Metric Sizes			
Clamping Range	mm		Part No
	mm	in	
1.0-0.5	.039-.019	80-001	
1.5-1.0	.059-.039	80-002	
2.0-1.5	.079-.059	80-003	
2.5-2.0	.098-.079	80-004	
3.0-2.5	.118-.098	80-005	
3.5-3.0	.138-.118	80-006	
4.0-3.5	.157-.138	80-007	
4.5-4.0	.177-.157	80-008	
5.0-4.5	.197-.177	80-009	
9 Pc. Set		80-010	

ER-16 Adaptor System

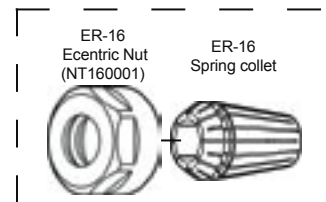
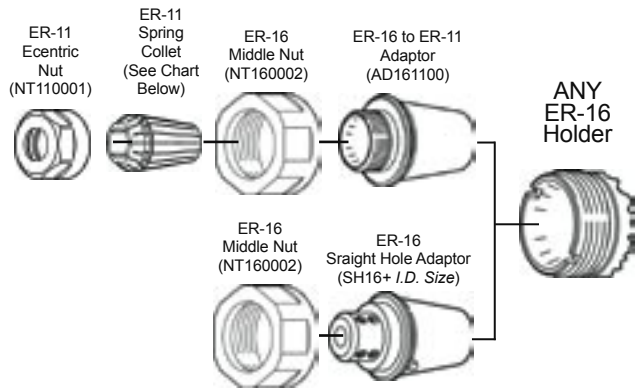

ER-11 Collets

Metric Sizes			Inch Sizes	
Clamping Range	mm		Dia.in	Part No
	mm	in		
1.0-0.5	.039-.019	110-001	1/16	110-501
1.5-1.0	.059-.039	110-002	3/32	110-502
2.0-1.5	.079-.059	110-003	1/8	110-503
2.5-2.0	.098-.079	110-004	5/32	110-504
3.0-2.5	.118-.098	110-005	3/16	110-505
3.5-3.0	.138-.118	110-006	7/32	110-506
4.0-3.5	.157-.138	110-007	1/4	110-507
4.5-4.0	.177-.157	110-008	7 pc set	110-508
5.0-4.5	.197-.177	110-009		
5.5-5.0	.217-.197	110-010		
6.0-5.5	.236-.217	110-011		
6.5-6.0	.256-.236	110-012		
7.0-6.5	.276-.256	110-013		
13 Pc Set		110-014		

AMERICAN QC SYSTEMS

Quick Switch Tooling

ER-20 Adaptor System

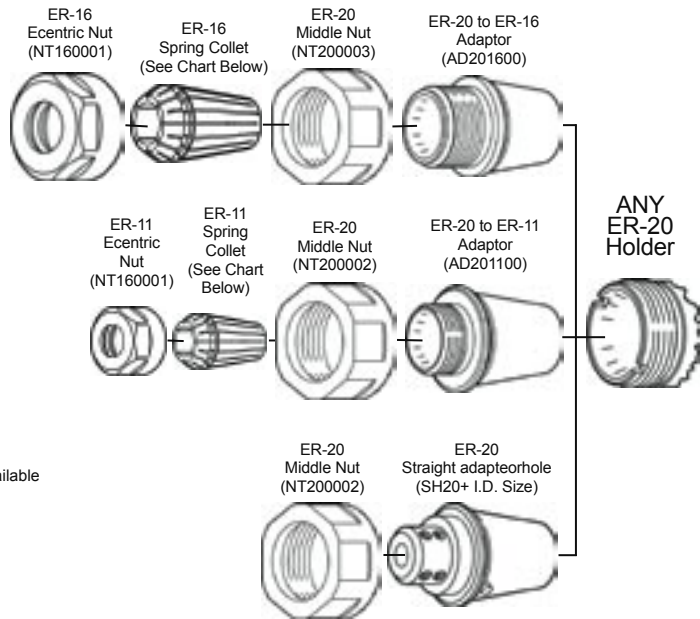

ER-20 Middle Nut also available with a M25x1.5 thread.
Part No: NT200003

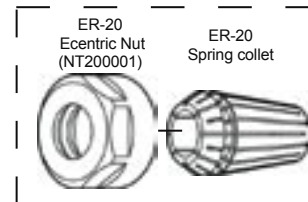

ER-11 Collets

ER-16 Collets

Metric Sizes		
Clamping Range		Part No
mm	in	
1.0-0.5	.039-.019	110-001
1.5-1.0	.059-.039	110-002
2.0-1.5	.079-.059	110-003
2.5-2.0	.098-.079	110-004
3.0-2.5	.118-.098	110-005
3.5-3.0	.138-.118	110-006
4.0-3.5	.157-.138	110-007
4.5-4.0	.177-.157	110-008
5.0-4.5	.197-.177	110-009
5.5-5.0	.217-.197	110-010
6.0-5.5	.236-.217	110-011
6.5-6.0	.256-.236	110-012
7.0-6.5	.276-.256	110-013
13 Pc Set		110-014

Inch Sizes	
Dia. in	Part No
1/16	110-501
3/32	110-502
1/8	110-503
5/32	110-504
3/16	110-505
7/32	110-506
1/4	110-507
7 pc set	110-508

Metric Sizes			
Clamping Range		Part No	Part No
mm	in		
1.0-0.5	.039-.019	160-001	
1.5-1.0	.059-.039		160-101
2.0-1.0	.079-.039	160-002	
2.5-1.5	.098-.059		160-102
3.0-2.0	.118-.079	160-003	
3.5-2.5	.138-.098		160-103
4.0-3.0	.157-.118	160-004	
4.5-3.5	.177-.138		160-104
5.0-4.0	.197-.157	160-005	
5.5-4.5	.217-.177		160-105
6.0-5.0	.236-.197	160-006	
6.5-5.5	.256-.217		160-106
7.0-6.0	.276-.236	160-007	
7.5-6.5	.296-.256		160-107
8.0-7.0	.315-.276	160-008	
8.5-7.5	.355-.296		160-108
9.0-8.0	.354-.315	160-009	
9.5-8.5	.374-.335		160-109
10.0-9.0	.394-.354	160-010	
10 Pc Set		160-011	

Inch Sizes	
Dia.in	Part No
1/16	160-501
3/32	160-502
1/8	160-503
5/32	160-504
3/16	160-505
7/32	160-506
1/4	160-507
9/32	160-508
5/16	160-509
11/32	160-510
3/8	160-511
13/32	160-512
12 pc set	160-513

AMERICAN QC SYSTEMS
Quick Switch Tooling

ER-25 Adaptor System

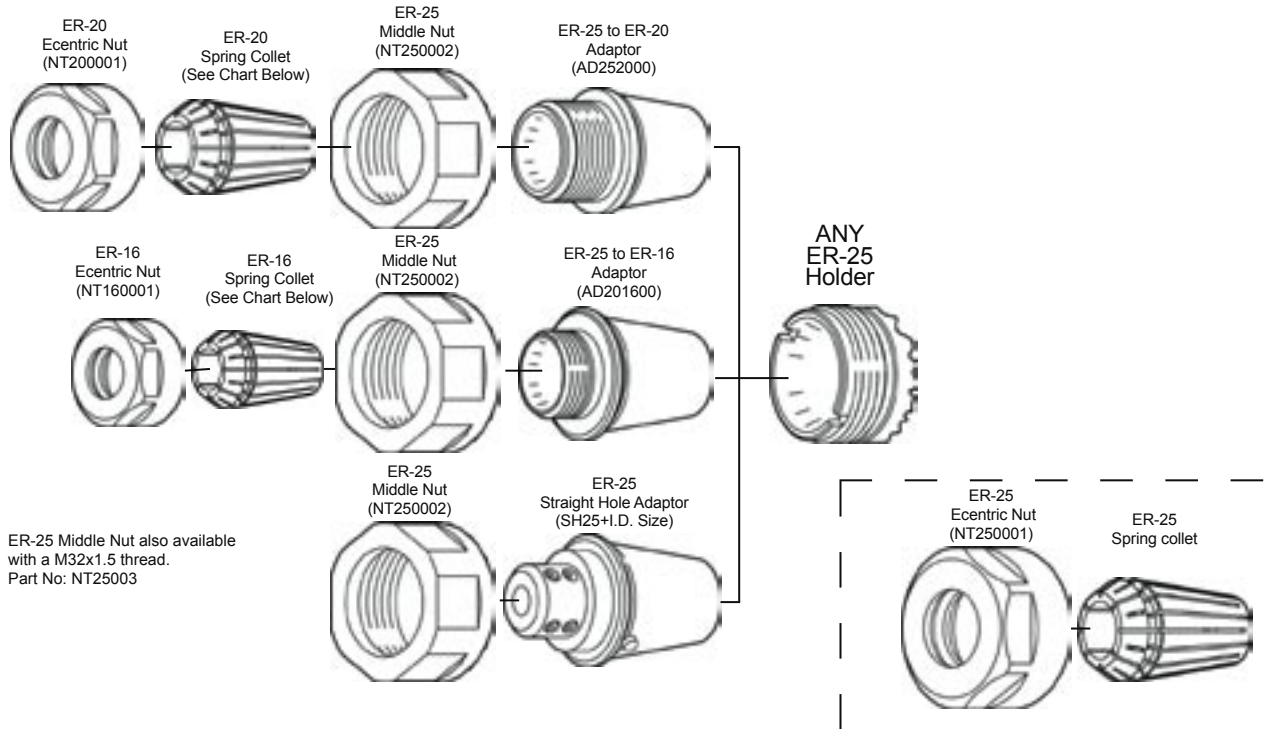

ER-16 Collets

ER-20 Collets

Metric Sizes			
Clamping Range		Part No	Part No
mm	in		
1.0-0.5	.039-.019	160-001	
1.5-1.0	.059-.039		160-101
2.0-1.0	.079-.039	160-002	
2.5-1.5	.098-.059		160-102
3.0-2.0	.118-.079	160-003	
3.5-2.5	.138-.098		160-103
4.0-3.0	.157-.118	160-004	
4.5-3.5	.177-.138		160-104
5.0-4.0	.197-.157	160-005	
5.5-4.5	.217-.177		160-105
6.0-5.0	.236-.197	160-006	
6.5-5.5	.256-.217		160-106
7.0-6.0	.276-.236	160-007	
7.5-6.5	.296-.256		160-107
8.0-7.0	.315-.276	160-008	
8.5-7.5	.355-.296		160-108
9.0-8.0	.354-.315	160-009	
9.5-8.5	.374-.335		160-109
10.0-9.0	.394-.354	160-010	
10 Pc Set		160-011	

Inch Sizes	
Dia.in	Part No
1/16	160-501
3/32	160-502
1/8	160-503
5/32	160-504
3/16	160-505
7/32	160-506
1/4	160-507
9/32	160-508
5/16	160-509
11/32	160-510
3/8	160-511
13/32	160-512
12 pc set	160-513

Metric Sizes			
Clamping Range		Part No	Part No
mm	in		
1.0-0.5	.039-.019		200-100
1.5-1.0	.059-.039		200-101
2.0-1.0	.079-.039	200-001	
2.5-1.5	.098-.059		200-102
3.0-2.0	.118-.079	200-002	
3.5-2.5	.138-.098		200-103
4.0-3.0	.157-.118	200-003	
4.5-3.5	.177-.138		200-104
5.0-4.0	.197-.157	200-004	
5.5-4.5	.217-.177		200-105
6.0-5.0	.236-.197	200-005	
6.5-5.5	.256-.217		200-106
7.0-6.0	.276-.236	200-006	
7.5-6.5	.296-.256		200-107
8.0-7.0	.315-.276	200-007	
8.5-7.5	.355-.296		200-108
9.0-8.0	.354-.315	200-008	
9.5-8.5	.374-.335		200-109
10.0-9.0	.394-.354	200-009	
10.5-9.5	.414-.374		200-110
11.0-10.0	.433-.394	200-010	
11.5-10.5	.453-.414		200-111
12.0-11.0	.472-.433	200-011	
12.5-11.5	.493-.453		200-112
13.0-12.0	.512-.472	200-012	
12 Pc Set		200-013	

Inch Sizes	
Dia. in	Part No
1/16	200-501
3/32	200-502
1/8	200-503
5/32	200-504
3/16	200-505
7/32	200-506
1/4	200-507
9/32	200-508
5/16	200-509
11/32	200-510
3/8	200-511
13/32	200-512
7/16	200-513
15/32	200-514
1/2	200-515
15 pc set	200-516

AMERICAN QC SYSTEMS

Quick Switch Tooling

ER-32 Adaptor System

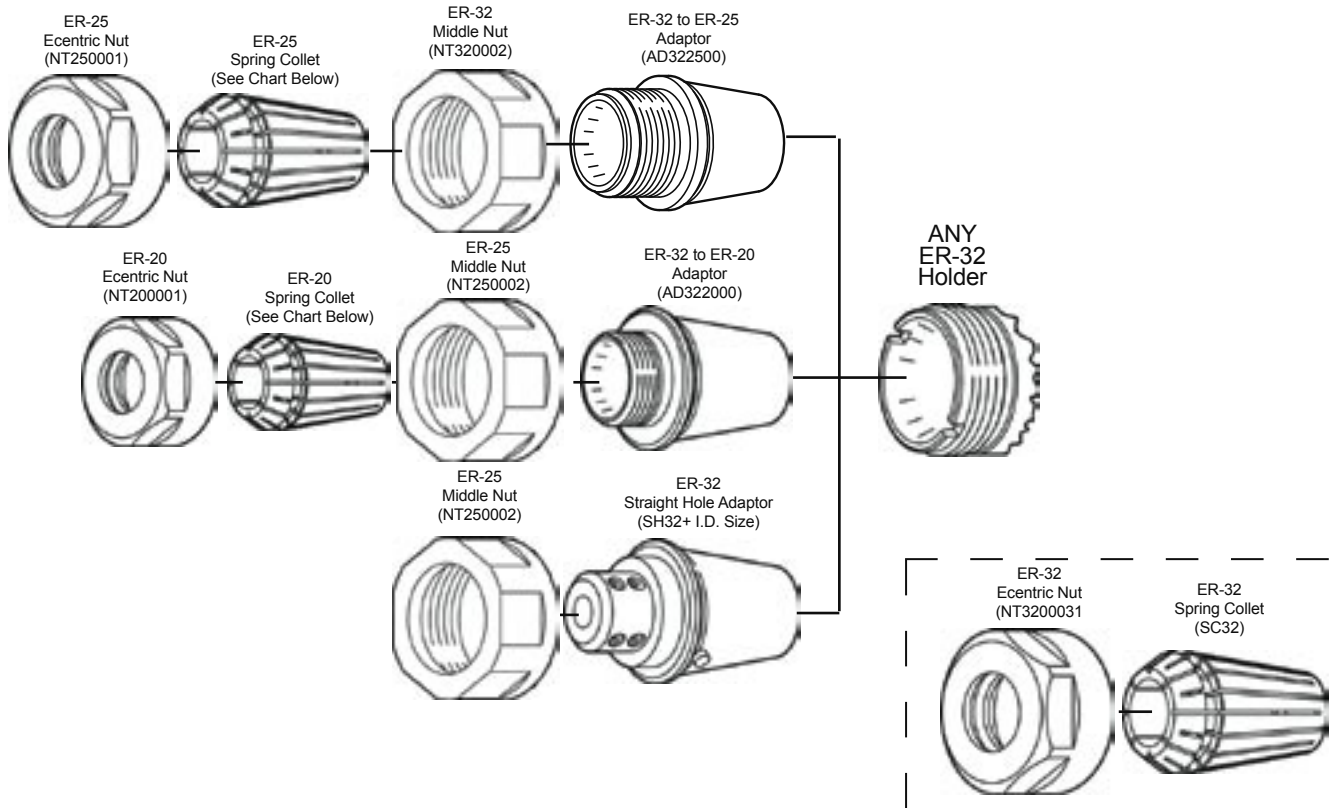

ER-20 Collets

ER-25 Collets

Metric Sizes			
Clamping Range mm	Clamping Range in	Part No	Part No
1.0-0.5	.039-.019		200-100
1.5-1.0	.059-.039		200-101
2.0-1.0	.079-.039	200-001	
2.5-1.5	.098-.059		200-102
3.0-2.0	.118-.079	200-002	
3.5-2.5	.138-.098		200-103
4.0-3.0	.157-.118	200-003	
4.5-3.5	.177-.138		200-104
5.0-4.0	.197-.157	200-004	
5.5-4.5	.217-.177		200-105
6.0-5.0	.236-.197	200-005	
6.5-5.5	.256-.217		200-106
7.0-6.0	.276-.236	200-006	
7.5-6.5	.296-.256		200-107
8.0-7.0	.315-.276	200-007	
8.5-7.5	.355-.296		200-108
9.0-8.0	.354-.315	200-008	
9.5-8.5	.374-.335		200-109
10.0-9.0	.394-.354	200-009	
10.5-9.5	.414-.374		200-110
11.0-10.0	.433-.394	200-010	
11.5-10.5	.453-.414		200-111
12.0-11.0	.472-.433	200-011	
12.5-11.5	.493-.453		200-112
13.0-12.0	.512-.472	200-012	
12 Pc Set		200-013	

Inch Sizes	
Dia.in	Part No
1/16	200-501
3/32	200-502
1/8	200-503
5/32	200-504
3/16	200-505
7/32	200-506
1/4	200-507
9/32	200-508
5/16	200-509
11/32	200-510
3/8	200-511
13/32	200-512
7/16	200-513
15/32	200-514
1/2	200-515
15 pc set	200-516

Metric Sizes			
Clamping Range mm	Clamping Range in	Part No	Part No
1.0-0.5	.039-.019		250-100
1.5-1.0	.059-.039		250-101
2.0-1.0	.079-.039	250-001	
2.5-1.5	.098-.059		250-102
3.0-2.0	.118-.079	250-002	
3.5-2.5	.138-.098		250-103
4.0-3.0	.157-.118	250-003	
4.5-3.5	.177-.138		250-104
5.0-4.0	.197-.157	250-004	
5.5-4.5	.217-.177		250-105
6.0-5.0	.236-.197	250-005	
6.5-5.5	.256-.217		250-106
7.0-6.0	.276-.236	250-006	
7.5-6.5	.296-.256		250-107
8.0-7.0	.315-.276	250-007	
8.5-7.5	.355-.296		250-108
9.0-8.0	.354-.315	250-008	
9.5-8.5	.374-.335		250-109
10.0-9.0	.394-.354	250-009	
10.5-9.5	.414-.374		250-110
11.0-10.0	.433-.394	250-010	
11.5-10.5	.453-.414		250-111
12.0-11.0	.472-.433	250-011	
12.5-11.5	.493-.453		250-112
13.0-12.0	.512-.472	250-012	
13.5-12.5	.532-.493		250-113
14.0-13.0	.551-.512	250-013	
14.5-13.5	.571-.532		250-114
15.0-14.0	.591-.551	250-014	
15.5-14.5	.611-.571		250-115
16.0-15.0	.630-.591	250-015	
15 Pc Set		250-016	

Inch Sizes	
Dia.in	Part No
1/16	250-501
3/32	250-502
1/8	250-503
5/32	250-504
3/16	250-505
7/32	250-506
1/4	250-507
9/32	250-508
5/16	250-509
11/32	250-510
3/8	250-511
13/32	250-512
7/16	250-513
15/32	250-514
1/2	250-515
17/32	250-516
9/16	250-517
19/32	250-518
5/8	250-519
19 Pc Set	250-520

AMERICAN QC SYSTEMS

Quick Switch Tooling

ER-40 Adaptor System

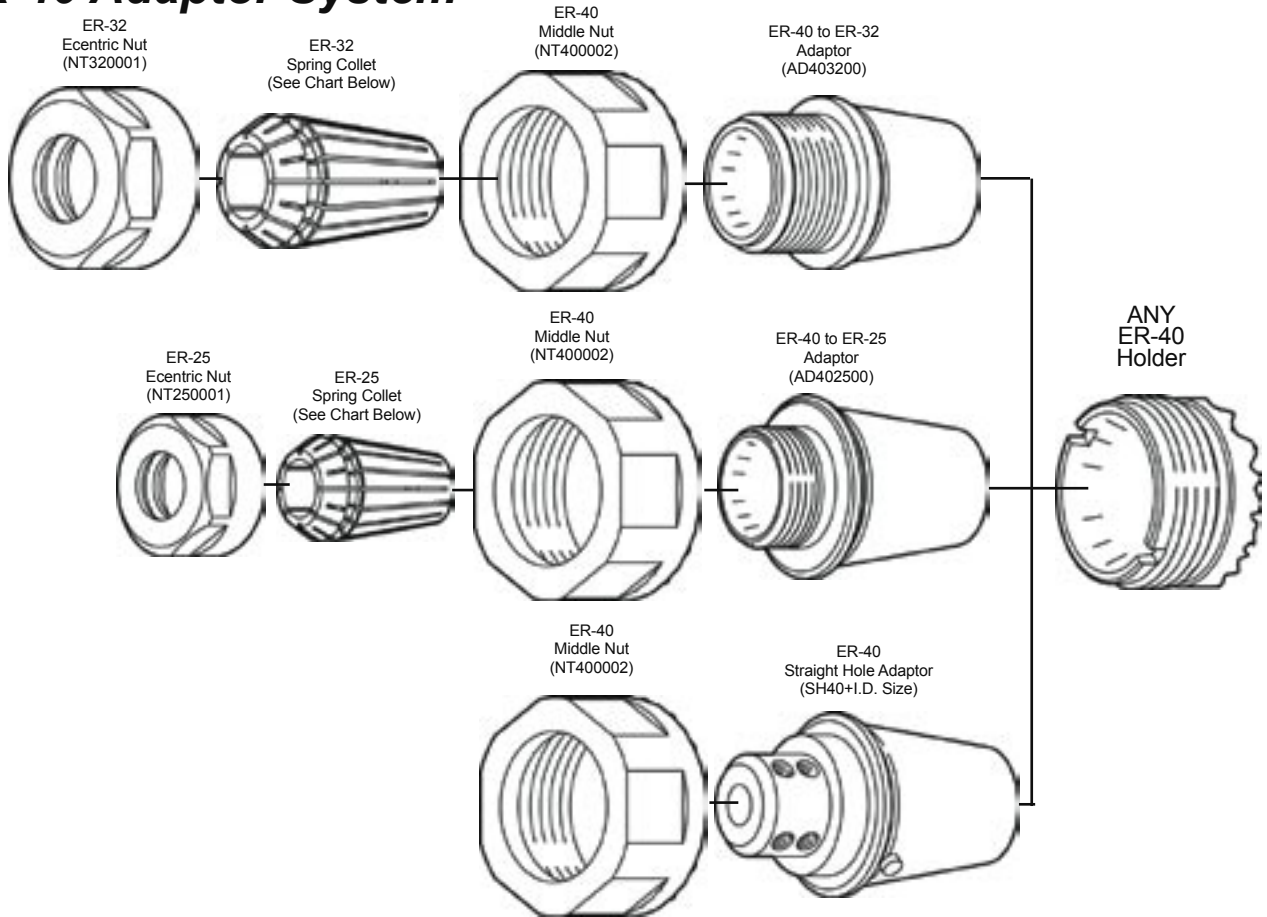

ER-25 Collets

Metric Sizes			
Clamping Range mm	in	Part No	Part No
1.0-0.5	.039-.019		250-100
1.5-1.0	.059-.039		250-101
2.0-1.0	.079-.039	250-001	
2.5-1.5	.098-.059		250-102
3.0-2.0	.118-.079	250-002	
3.5-2.5	.138-.098		250-103
4.0-3.0	.157-.118	250-003	
4.5-3.5	.177-.138		250-104
5.0-4.0	.197-.157	250-004	
5.5-4.5	.217-.177		250-105
6.0-5.0	.236-.197	250-005	
6.5-5.5	.256-.217		250-106
7.0-6.0	.276-.236	250-006	
7.5-6.5	.296-.256		250-107
8.0-7.0	.315-.276	250-007	
8.5-7.5	.355-.296		250-108
9.0-8.0	.354-.315	250-008	
9.5-8.5	.374-.335		250-109
10.0-9.0	.394-.354	250-009	
10.5-9.5	.414-.374		250-110
11.0-10.0	.433-.394	250-010	
11.5-10.5	.453-.414		250-111
12.0-11.0	.472-.433	250-011	
12.5-11.5	.493-.453		250-112
13.0-12.0	.512-.472	250-012	
13.5-12.5	.532-.493		250-113
14.0-13.0	.551-.512	250-013	
14.5-13.5	.571-.532		250-114
15.0-14.0	.591-.551	250-014	
15.5-14.5	.611-.571		250-115
16.0-15.0	.630-.591	250-015	
	15 Pc Set	250-016	

Inch Sizes	
Dia.in	Part No
1/16	250-501
3/32	250-502
1/8	250-503
5/32	250-504
3/16	250-505
7/32	250-506
1/4	250-507
9/32	250-508
5/16	250-509
11/32	250-510
3/8	250-511
13/32	250-512
7/16	250-513
15/32	250-514
1/2	250-515
17/32	250-516
9/16	250-517
19/32	250-518
5/8	250-519
19 Pc Set	250-520

ER-32 Collets

Metric Sizes			
Clamping Range mm	in	Part No	Part No
3.0-2.0	.118-.079	320-001	
3.5-2.5	.138-.098		320-103
4.0-3.0	.157-.118	320-002	
4.5-3.5	.177-.138		320-104
5.0-4.0	.197-.157	320-003	
5.5-4.5	.217-.177		320-105
6.0-5.0	.236-.197	320-004	
6.5-5.5	.256-.217		320-106
7.0-6.0	.276-.236	320-005	
7.5-6.5	.296-.256		320-107
8.0-7.0	.315-.276	320-006	
8.5-7.5	.355-.296		320-108
9.0-8.0	.354-.315	320-007	
9.5-8.5	.374-.335		320-109
10.0-9.0	.394-.354	320-008	
10.5-9.5	.414-.374		320-110
11.0-10.0	.433-.394	320-009	
11.5-10.5	.453-.414		320-111
12.0-11.0	.472-.433	320-010	
12.5-11.5	.493-.453		320-112
13.0-12.0	.512-.472	320-011	
13.5-12.5	.532-.493		320-113
14.0-13.0	.551-.512	320-012	
14.5-13.5	.571-.532		320-114
15.0-14.0	.591-.551	320-0113	
15.5-14.5	.611-.571		320-115
16.0-15.0	.630-.591	320-014	
16.5-15.5	.650-.611		320-116
17.0-16.0	.669-.630	320-015	
17.5-16.5	.690-.650		320-117
18.0-17.0	.709-.669	320-016	
18.5-17.5	.729-.690		320-118
19.0-18.0	.748-.709	320-017	
19.5-18.5	.768-.729		320-119
20.0-19.0	.787-.748	320-018	
	18 Pc Set	320-019	

Inch Sizes	
Dia.in	Part No
3/32	320-501
1/8	320-502
5/32	320-503
3/16	320-504
7/32	320-505
1/4	320-506
9/32	320-507
5/16	320-508
11/32	320-509
3/8	320-510
13/32	320-511
7/16	320-512
15/32	320-513
1/2	320-514
17/32	320-515
9/16	320-516
19/32	320-517
5/8	320-518
21/32	320-519
11/16	320-520
23/32	320-521
3/4	320-522
22 Pc Set	320-523

AMERICAN QC SYSTEMS
Quick Switch Tooling

Canisters (nut not included)

SIZE	Part Number	List
ER-16	CN160001	63.00
ER-20	CN200002	94.00
ER-25	CN250002	94.00
ER-32	CN320003	145.00
ER-40	CN400003	145.00

Canister Holders

SIZE	Part Number	List
1/2"	CH010500	69.00
5/8"	CH010625	69.00
3/4"	CH010750	69.00
20mm	CH010787	69.00
22mm	CH010866	69.00
3/4"	CH020750	69.00
1"	CN021000	69.00
1-1/4"	CH021250	69.00
32mm	CH021260	69.00
1-1/2"	CH021500	69.00
1-1/2"	CH031500	139.00
2"	CH032000	139.00

Straight Shank ER Holders

Shank Size	ER Size	Part Number	List
1/2"	16	SS160500	65.00
5/8"	16	SS160625	65.00
3/4"	16	SS160750	59.00
1"	16	SS161000	59.00
20mm	16	SS160787	59.00
20mm, DE	16	SS1620DE	65.00
22mm	16	SS160866	59.00
22mm, DE	16	SS1622DE	65.00
3/4"	20	SS200750	69.00
22mm	20	SS200866	69.00
1"	20	SS201000	69.00
1-1/4"	20	SS201250	69.00
32mm	20	SS201260	69.00
3/4"	25	SS250750	83.00
1"	25	SS251000	83.00
1-1/4"	25	SS251250	83.00
1-1/2"	25	SS251500	83.00
1"	32	SS321000	99.00
1-1/4"	32	SS321250	99.00
1-1/2"	32	SS321500	99.00
2"	32	SS322000	99.00
1-1/4"	40	SS401250	125.00
1-1/2"	40	SS401500	125.00
2"	40	SS402000	125.00

AMERICAN QC SYSTEMS

Quick Switch Tooling

Assembly Sizes	Part Number	Description	LIST
ER-11 to ER-8	AS110801	4 pc assembly w/small middle nut (M13x.75) - specify spring collet size	75.00
	AS110802	4 pc assembly w/large middle nut (M14x.75) - specify spring collet size	75.00
	AS110803	3 pc assembly w/small middle nut (M13x.75) - no spring collet	59.00
	AS110804	3 pc assembly w/large middle nut (M14x.75) - no spring collet	59.00
ER-16 to ER-11	AS161101	4 pc assembly w/small middle nut (M19x1.0) - specify spring collet size	75.00
	AS161102	4 pc assembly w/large middle nut (M22x1.5) - specify spring collet size	75.00
	AS161103	3 pc assembly w/small middle nut (M19x1.0) - no spring collet	59.00
	AS161104	3 pc assembly w/large middle nut (M22x1.5) - no spring collet	59.00
ER-20 to ER-16	AS201601	4 pc assembly w/small middle nut (M24x1.0) - specify spring collet size	85.00
	AS201602	4 pc assembly w/large middle nut (M25x1.5) - specify spring collet size	85.00
	AS201603	3 pc assembly w/small middle nut (M24x1.0) - no spring collet	69.00
	AS201604	3 pc assembly w/large middle nut (M25x1.5) - no spring collet	69.00
ER-20 to ER-11	AS201101	4 pc assembly w/small middle nut (M24x1.0) - specify spring collet size	*85.00
	AS201102	4 pc assembly w/large middle nut (M25x1.5) - specify spring collet size	*85.00
	AS201103	3 pc assembly w/small middle nut (M24x1.0) - no spring collet	*69.00
	AS201104	3 pc assembly w/large middle nut (M25x1.5) - no spring collet	*69.00
ER-25 to ER-20	AS252001	4 pc assembly w/small middle nut (M30x1.0) - specify spring collet size	95.00
	AS252002	4 pc assembly w/large middle nut (M32x1.5) - specify spring collet size	95.00
	AS252003	3 pc assembly w/small middle nut (M30x1.0) - no spring collet	79.00
	AS252004	3 pc assembly w/large middle nut (M32x1.5) - no spring collet	79.00
ER-25 to ER-16	AS251601	4 pc assembly w/small middle nut (M30x1.0) - specify spring collet size	*95.00
	AS251602	4 pc assembly w/large middle nut (M32x1.5) - specify spring collet size	*95.00
	AS251603	3 pc assembly w/small middle nut (M30x1.0) - no spring collet	*79.00
	AS251604	3 pc assembly w/large middle nut (M32x1.5) - no spring collet	*79.00
ER-32 to ER-25	AS322501	4 pc assembly - specify spring collet size	105.00
	AS322503	3 pc assembly - no spring collet	89.00
ER-32 to ER-20	AS322001	4 pc assembly - specify spring collet size	*105.00
	AS322003	3 pc assembly - no spring collet	*89.00
ER-40 to ER-32	AS403201	4 pc assembly - specify spring collet size	135.00
	AS403203	3 pc assembly - no spring collet	119.00
ER-40 to ER-25	AS402501	4 pc assembly - specify spring collet size	*135.00
	AS402503	3 pc assembly - no spring collet	*119.00

* = 10% Discount if customer request no middle nut.

Straight Hole Adaptors w/nut			Spring Collets	
Assembly	Part Number	List	Size	LIST
ER-16	SH160XXX	*68.00	ER-8	22.40
ER-20	SH200XXX	*79.00	ER-11	18.00
ER-25	SH250XXX	*89.00	ER-16	18.00
ER-32	SH320XXX	*122.00	ER-20	18.00
			ER-25	21.60
			ER-32	21.60

* = 10% Discount if customer requests no middle nut.

xxx = Specify Hole Size